

51087HOM UM - Fosmon QSG

Height: 75 mm

Width: 75 mm

Style: Fold

size: 75x75mm 2023.10.23

Front



Fosmon 113dB Waterproof IP65 Wireless Anti-Theft Vibration Alarm with Remote Control SKU 51087HOM

User Manual

Go to fosmon.com for video instructions



DO NOT RETURN THE PRODUCT
There are good days and there are bad days. It is our BAD if the product is not working, or if you are not happy with it. PLEASE GIVE US A CHANCE and WE WILL MAKE IT RIGHT.
1-833-3-Fosmon (833-336-7666)
(612) 435-7508
support@fosmon.com

V10042023.1

Thank you for purchasing this Fosmon product. For optimum performance and safety, please read this user manual carefully before operating and keep it for future reference.

Fosmon's 113dB Waterproof IP65 wireless anti-theft vibration alarm with remote control is a great way for keeping your bicycle and other items secure.

Package Includes

- 2x Cable Tie
- 2x Double Sided Tape
- 1x Triangular Plate
- 1x Remote w/ Battery
- 1x Screwdriver
- 3x AAA Battery
- 1x Alarm
- 1x Quick Start Guide

Specifications

Operating Humidity	<80%
Operating Temperature	-4~ 140°F (-20~60°C)
Decibel	113db
Water Resistance	IP65
Alarm Battery Requirement	3x AAA
Alarm Standby Time	6 Months
Remote Battery Requirement	1x 27A
Remote Run Time	> 1 Year (5 Times/Day)

Remote Layout

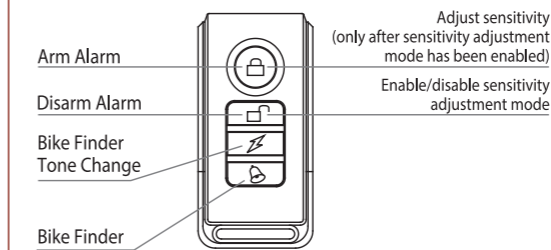

(Please refer to pages 4 and 5 for additional instructions for remote functions)

Mounting Instructions

- Unit Can be mounted using adhesive tape or cable tie
- 1 - Thoroughly clean and dry desired surface area
 - 2 - Apply adhesive on to the back of alarm and place on desired surface or
 - 3 - Thread cable tie through brackets on back of alarm and tie around desired item.

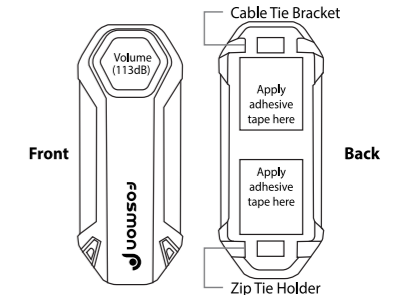

Back

Functions and Settings

Sensitivity Adjustment

- There are 7 sensitivity levels measured in musical pitches, Do, Re, Mi, Fa, So, La, Ti
- Do = Highest Sensitivity
- Ti = Lowest Sensitivity

1. Press and hold (□) for about 6 seconds, and the LED will turn off and then back on.
2. Press (□) once, and it will sound from Do up to your current sensitivity setting.
3. Repeatedly press (□) until you hear the desired musical pitch.
4. Once desired sensitivity is confirmed, press (□) once to exit the setting.

Volume Adjustment

1. Press and hold (□) for about 6 seconds, and the LED will turn off and then back on.
2. Press (⏮) to cycle through the 3 volume levels.
3. Once the desired volume is confirmed, press (□) once to exit the setting.

SOS Function

- SOS function is off in default mode.
- SOS function responds to being tilted 45° from its initial position of when the function is enabled. (For example, if bike falls over)

- To Turn On SOS

1. Press and hold (□) for about 6 seconds, and the LED will turn off and then back on.
2. Press (⚡) and the alarm will beep 1 time. Press it again and it will beep 5 times to indicate SOS is on.

- To Turn Off SOS

1. Press and hold (□) for 6 seconds, and the LED will turn off and then back on.
2. Press (⚡) and the alarm will beep 2 times to indicate SOS is off.

Remote Pairing and Reset

- The remote and alarm are already paired out of the box.
- One alarm can be paired with up to 8 remotes.

- To Pair the First Remote to an Alarm

1. Remove the alarm batteries and install them back after 30 seconds.
2. Press and hold (⏮) for about 6 seconds.
3. Press ARM or DISARM button, and the alarm will beep twice to indicate they are paired.

- To Add More Remotes to an Alarm

1. Disarm the alarm.
2. Press and hold the old remote's (⏮) for about 6 seconds.
3. Press the new remote's ARM or DISARM button, and the alarm will beep twice to indicate they are paired.

- To Reset an Alarm (Remove all remotes paired with the alarm)

1. Disarm the alarm.
2. Press and hold (⏮) for about 6 seconds.
3. Press (⚡), and the alarm will beep 3 times to indicate all remotes are un-paired.

Alarm Battery Replacement

- Unit Note: Alarm battery is 3x AAA and pre-installed in each unit
- Low Battery Indicator: When arming/disarming alarm will beep with an additional 2 "det...det" noise.

- 1 - Using the provided screwdriver, remove screw from the bottom of alarm.
- 2 - Insert triangular plate into opening on bottom and twist to separate each side.

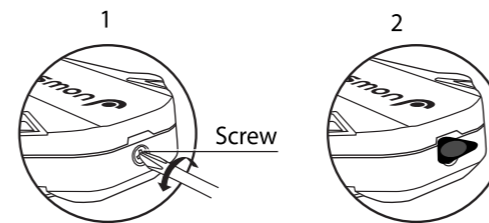

Remote Battery Replacement

- Note: Remote battery is 1x 27A and pre-installed in each unit
- Low Battery Indicator: LED will begin to dim and wireless range becomes shorter

- 1 - Using a flathead screwdriver, insert it into the grooves found on the left side of the remote (while upright) and pry upwards.
- 2 - Pry upwards around the remote's frame afterwards to separate the remote's front panel from the back panel.
- 3 - Separate the two panels and replace the battery.

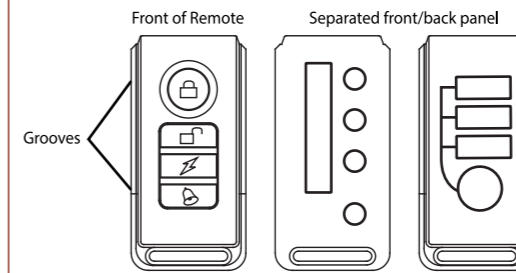

Follow Us On Social Media



www.fosmon.com
support@fosmon.com
© 2023 Fosmon Inc. All rights reserved.

Recycling the Product

To dispose this product properly, please follow the recycling process regulated in your area.

Limited Lifetime Warranty

This Fosmon product includes a limited lifetime warranty. Please visit our Fosmon website for more details.